

MRX series pumps

The mono- and multicellular centrifugal pumps in the **MRX** series are specially designed for the transfer or flow of thermal, corrosive or aggressive products. This pump technology allows operation at both negative and positive **extreme temperatures**.

Thanks to their horizontal mono-block design, the **MRX** series pumps do not take up a lot of space, making their integration into compact "Skid" types of assemblies easier. The pump and the motor form a mono-block set connected by flanges, with a common shaft.

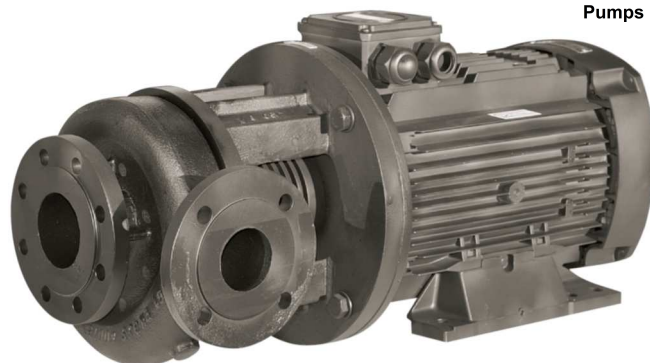

LIMITS OF USE

- Flow rate: 100 l/h to 100 m³/h
- Total head: <105 m
- Operating temperature: - 110°C to + 350°C
- Operating pressure: < 10 bar
- Speed: < 3600 min⁻¹
- ATEX certification: II 2 G II B T3/T4

SELECTION CURVES

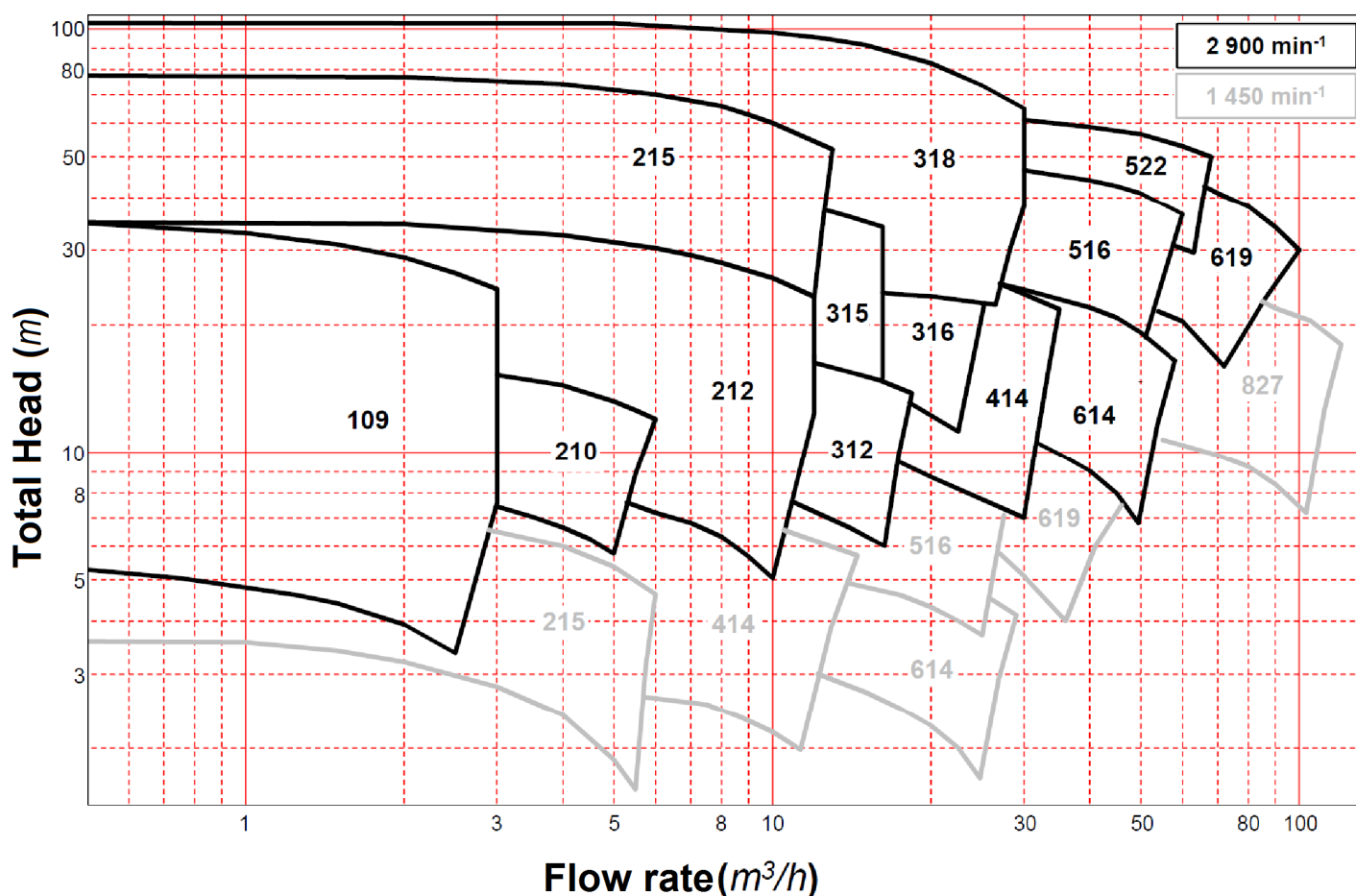

Please contact us to see the 1450 rpm/min speed selection curves.

BUSINESS ACTIVITIES AND PRINCIPAL USE

Heat transfer and refrigerating fluids - Transferring corrosive liquids or solvents - Chemical and fine chemicals industries
Paper-making industry - Skid manufacturers - Cement works...

POMPES GROSCLAUDE

Technical sheet n°: n°: MRX-13-EN

SPECIFICATIONS

Basic components

- Pump body
- Cover/diffuser/flange
- Impeller
- Shaft
- Heat exchanger
- Lantern
- Gasket

316L Stainless steel
316L Stainless steel
316L Stainless steel
329LN Stainless steel
316L Stainless steel
304 stainless steel
Aramid

To better respond to your requirements, our expertise in the metalworking industry is at your service:

Hastelloy, Duplex...

(can be modified according to your needs)

Mechanical seal

- Assembly
- Lubrication
- Friction face
- O-ring

Single mechanical seal
Process fluid
SiC/C
FPM FPM

We'll help you define the best type of assembly and dynamic sealing adapted to your application.

Pump inlet and outlet connections

Type	MRX 109	MRX 210	MRX 215	MRX 315	MRX 316	MRX 318	MRX 414	MRX 516	MRX 522	MRX 614	MRX 619
Inlet	DN20PN16	DN20PN16	DN32PN16	DN40PN16	DN50PN16	DN40PN16	DN40PN16	DN80PN16	DN65PN16	DN65PN16	DN80PN16
Outlet	DN15PN16	DN20PN16	DN25PN16	DN32PN16	DN32PN16	DN32PN16	DN40PN16	DN50PN16	DN50PN16	DN65PN16	DN65PN16

Motor Three-phase (other voltage on request)

Finishing Primer + epoxy paint RAL # 5017



OVERALL DIMENSIONS

Type	Motor Power (kW)	Size Data						Weight (kg)
		K (mm)	A (mm)	B (mm)	E (mm)	H (mm)	S (mm)	
MRX 109	0,37	55	405	193	140	71	151	14
MRX 109/2	0,37	70	420	193	140	71	151	15
MRX 109/3	0,55	92	442	193	140	71	151	17
MRX 210	0,55	44	380	193	155	71	181	15
MRX 215	2,20	75	545	254	170	90	220	57
MRX 215/2	2,20	105	575	254	170	90	220	57
MRX 315	2,20	77	570	254	170	90	235	61
MRX 315/2	3,00	87	600	278	200	100	245	70
MRX 316	5,50	80	775	381	272	132	292	110
MRX 318/2	9,00	123	805	391	272	132	292	114
MRX 318/3	11,00	159	840	391	272	132	292	128
MRX 414	3,00	70	620	278	200	100	245	60
MRX 516	9,00	100	805	381	272	132	312	120
MRX 522	18,50	115	985	470	350	180	380	205
MRX 614	5,50	81	775	381	272	132	302	122
MRX 619	15,00	80	885	445	318	160	380	230

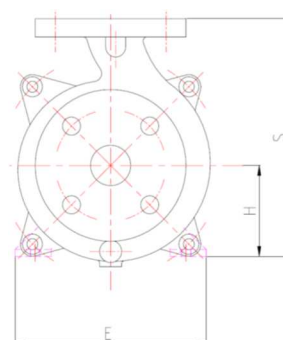
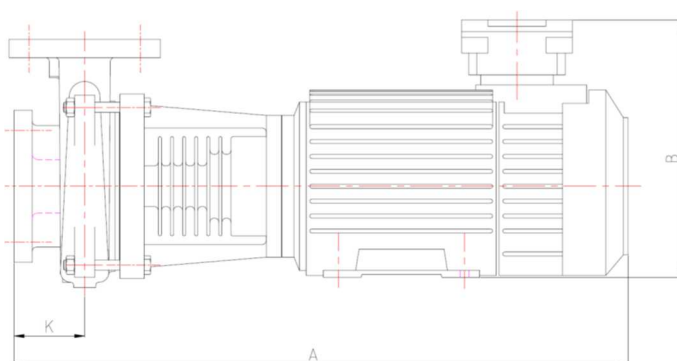

You can choose the position of the outlet and inlet when ordering

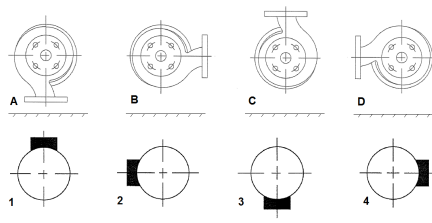

Our standard is C orientation

Dimensions shown are for reference only and can be different according to the type of motor used.

PART NUMBER

MRX	109	/2	X	-	95/90	-	0,37	-	2	A	-	12555
	Size	Number of impellers	Material in contact with the liquid		Ø of the impellers		Power in kW		Motor installed			Serial No.
	109	1 impeller	X Stainless Steel 316L						2 2 poles (# 2 900 rpm)			
	215	/2 2 impellers	XG Stainless Steel 304						4 4 poles (# 1 450 rpm)			
	...	/3 3 impellers								Protection		
	619									A ATEX		
										I non-ATEX		

POMPES GROSCLAUDE

Parc du chêne - 29, rue du 35^{ème} régiment d'aviation

69 500 BRON – FRANCE

Tel: (33) 4 72 37 94 00

Fax: (33) 4 72 37 94 01

E-mail: info@pompes-grosclaude.com

Web: www.pompes-grosclaude.com

