

MRseries pumps

The self-cooling, mono- and multicellular centrifugal pumps in the **MR** series are specially designed for the flow of **thermal fluids** and for use under **extreme temperatures**.

With a unique design that takes up less space, they easily integrate into industrial assemblies. Direct coupling, without motor alignment, ensures easy maintenance.

LIMITS OF USE

- Flow rate: 100 l/h to 100 m³/h
- Total head: <105 m
- Operating temperature: - 30°C to + 350°C
- Operating pressure: < 10 bar
- Speed: < 3600 min⁻¹
- ATEX certification:  II 2 G II B T3/T4



SELECTION CURVES

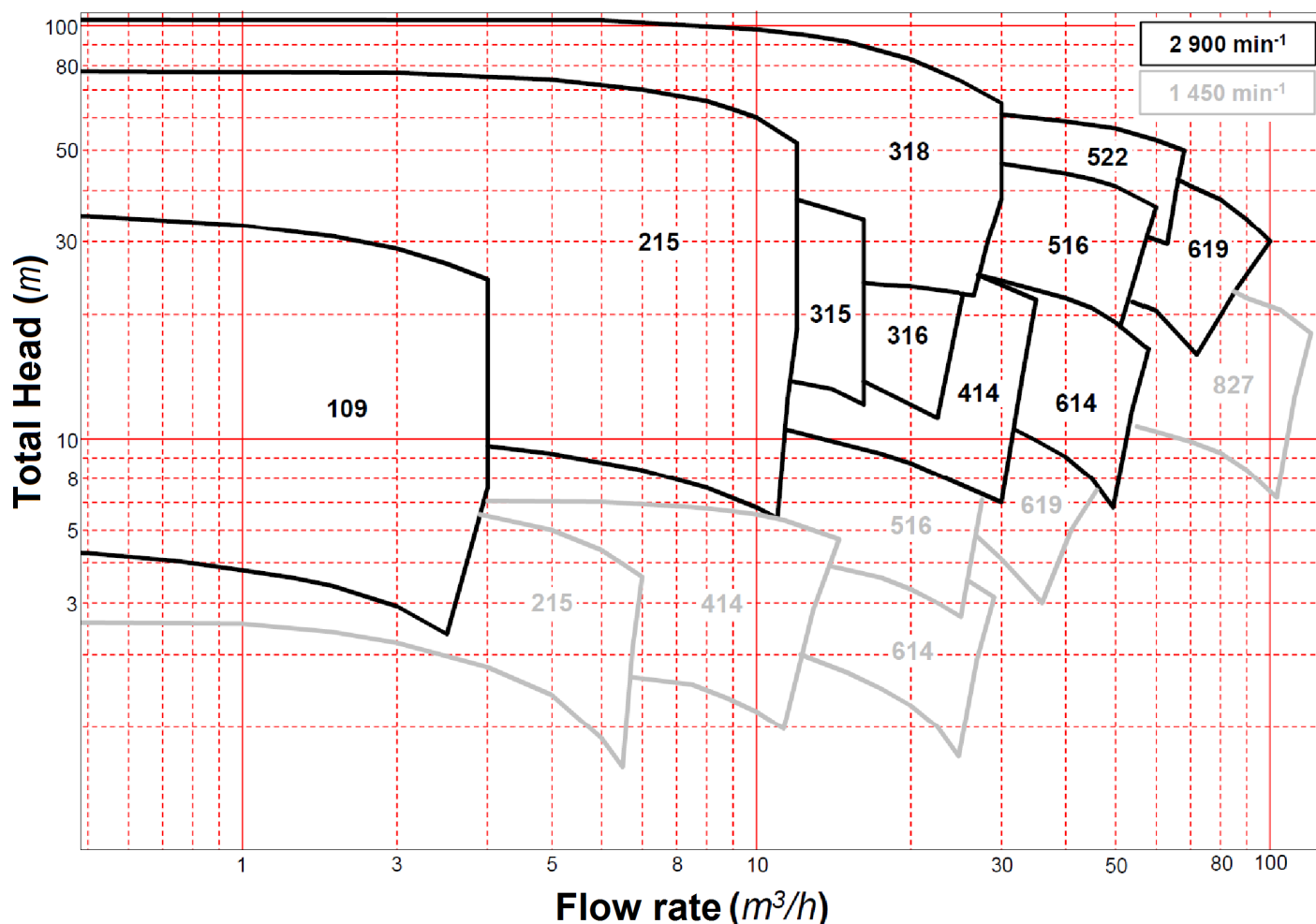

Please contact us to see the 1450 rpm/min speed selection curves.

BUSINESS ACTIVITIES AND PRINCIPAL USE

Heat transfer fluids - Thermal fluids - Skid manufacturers - Chemical and fine chemicals industries - Automotive industry - Engineering companies...

POMPES GROSCLAUDE

Technical sheet no.: MR-13-EN

SPECIFICATIONS

Basic components

- Pump body Nodular Cast Iron/Carbon steel
- Cover/diffuser/flange Nodular Cast Iron/Carbon steel
- Impeller 316L Stainless steel or GS Cast iron
- Shaft 329LN Stainless steel
- Heat exchanger Aluminium/steel
- Gasket Aramid

(can be modified according to your needs)

Mechanical seal

- Assembly Single mechanical seal
- Lubrication Process fluid
- Friction face Stainless steel/C
- O-ring FPM

Pump inlet and outlet connections

We'll help you define the best type of assembly and dynamic sealing adapted to your application.

Type	MR 109	MR 215	MR 315	MR 316	MR 318	MR 414	MR 516	MR 522	MR 614	MR 619
Inlet	DN20PN16	DN32PN16	DN40PN16	DN50PN16	DN40PN16	DN40PN16	DN80PN16	DN65PN16	DN65PN16	DN80PN16
Outlet	DN15PN16	DN25PN16	DN32PN16	DN32PN16	DN32PN16	DN40PN16	DN50PN16	DN50PN16	DN65PN16	DN65PN16



Motor

Three-phase (other voltage on request)

Finishing

High-temperature black paint

OVERALL DIMENSIONS

2900

Type	Motor Power (kW)	Size Data						Weight (kg)
		K (mm)	A (mm)	B (mm)	E (mm)	H (mm)	S (mm)	
MR 109	0,37	55	435	193	140	71	151	14
MR 109/2	0,37	70	450	193	140	71	151	15
MR 109/3	0,55	92	472	193	140	71	151	17
MR 215	2,20	75	605	254	170	90	220	57
MR 215/2	2,20	105	605	254	170	90	220	57
MR 315	2,20	77	600	254	170	90	235	61
MR 315/2	3,00	87	630	278	200	100	245	70
MR 316	5,50	80	805	381	272	132	292	110
MR 318/2	9,00	123	835	391	272	132	292	114
MR 318/3	11,00	159	870	391	272	132	292	128
MR 414	3,00	70	650	278	200	100	245	60
MR 516	9,00	100	835	381	272	132	312	120
MR 522	18,50	115	1015	470	350	180	380	205
MR 614	5,50	81	805	381	272	132	302	122
MR 619	15,00	80	915	445	318	160	380	230

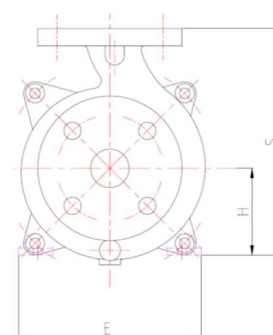
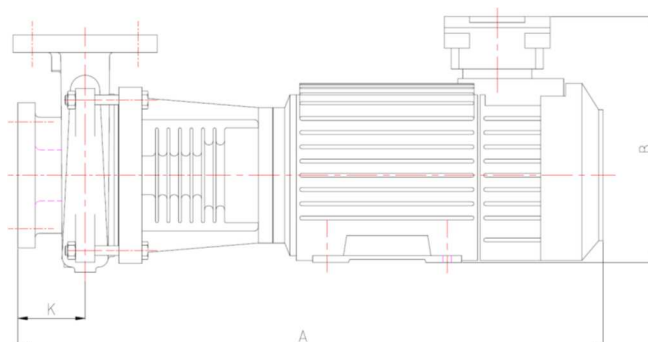

You can choose the position of the outlet and inlet when ordering

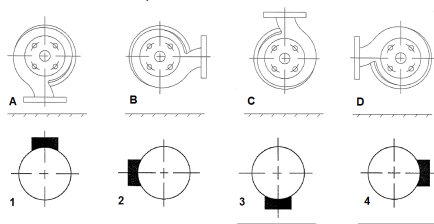

Our standard is position C1.

Dimensions shown are for reference only and can be different according to the type of motor used.

PART NUMBER

MR	109	/2	F	-	95/90	-	0,37	-	2	A	-	12555
	Size	Number of impellers	Material in contact with the liquid		Ø of the impellers		Power in kW		Motor installed			Serial No.
	109	1 impeller	F Nodular Cast Iron						2 2 poles (# 2 900 rpm)			
	215	/2 2 impellers	A Carbon Steel						4 4 poles (# 1 450 rpm)	A ATEX		
	...	/3 3 impellers								I non-ATEX		
	619											

POMPES GROSCLAUDE

Parc du chêne - 29, rue du 35^{ème} régiment d'aviation

69 500 BRON – FRANCE

Tel: (33) 4 72 37 94 00

Fax: (33) 4 72 37 94 01

E-mail: info@pompes-grosclaude.com

Web: www.pompes-grosclaude.com

