

# LR series pumps

The self-cooling centrifugal pumps in the **LR**, series are specially designed for the flow of **thermal fluids** and for use under **extreme temperatures**.

Because of their mono-block design and **In-Line** installation, **LR** pumps take up limited space, which makes their integration into compact Skid assemblies much easier.

The pump and the motor form a mono-block set connected by flanges, with a common shaft.



## LIMITS OF USE

- Flow rate: 1 to 60 m<sup>3</sup>/h
- Total head: < 40 m
- Operating temperature: - 30°C to + 350°C
- Operating pressure: < 10 bar
- Speed: < 3600 min<sup>-1</sup>
- ATEX certification:  II 2 G II B T2/T3/T4

## SELECTION CURVES

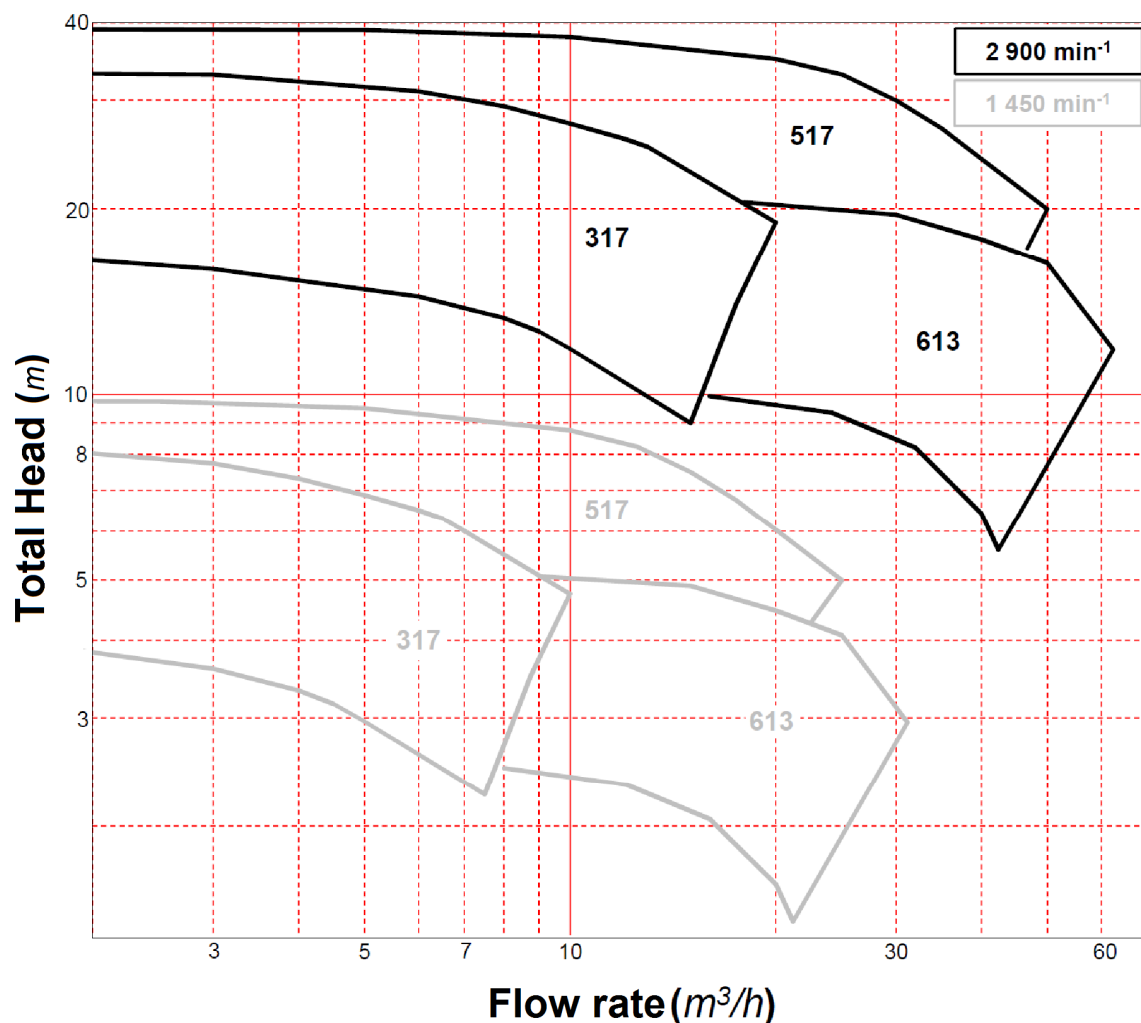

## BUSINESS ACTIVITIES AND PRINCIPAL USE

Heat transfer fluids - Thermal fluids - Skid manufacturers - Chemical and fine chemicals industries - Automotive industry - Engineering companies....

## SPECIFICATIONS

### Basic components

- Pump body
- Cover/diffuser/flange
- Impeller
- Shaft
- Heat exchanger
- Gasket

Nodular Cast Iron  
Nodular Cast Iron  
Nodular Cast Iron  
329LN Stainless steel  
Aluminium or Cast iron  
Aramid

To better respond to your requirements, our expertise in the metalworking industry is at your service:

***Stainless steel 304, 316, 316L...***

*(can be modified according to your needs)*

### Mechanical seal

- Assembly
- Lubrication
- Friction face
- O-ring

Single mechanical seal  
Process fluid  
SiC/C  
FPM

We'll help you define the best type of assembly and dynamic sealing adapted to your application.

### Pump inlet and outlet connections

Type	LR 317	LR 517	LR 613/34
Inlet	DN32PN16	DN50PN16	DN65PN16
Outlet	DN32PN16	DN50PN16	DN65PN16

### Motor

- Protection ATEX or non ATEX
- Three-phase (other voltage on request)

### Paint

- High temperature black finishing

*(can be modified on request)*



## OVERALL DIMENSIONS

Type	Motor		Size Data				Weight (kg)
	Power (kW)	Number of poles	A (mm)	B (mm)	E (mm)	D (mm)	
LR 317	1,10	4	540	164	260	210	44
LR 317	2,20	2	540	164	260	210	44
LR 517	2,20	4	590	178	360	227	60
LR 517	4,00	2	640	250	360	227	90
LR 517	5,50	2	680	250	360	227	110
LR 613/34	2,50	4	590	178	340	230	60
LR 613/34	4,00	2	645	250	340	230	90
LR 613/34	5,50	2	685	250	340	230	110

You can choose the position of the outlet when ordering

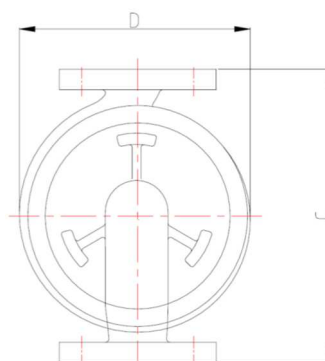
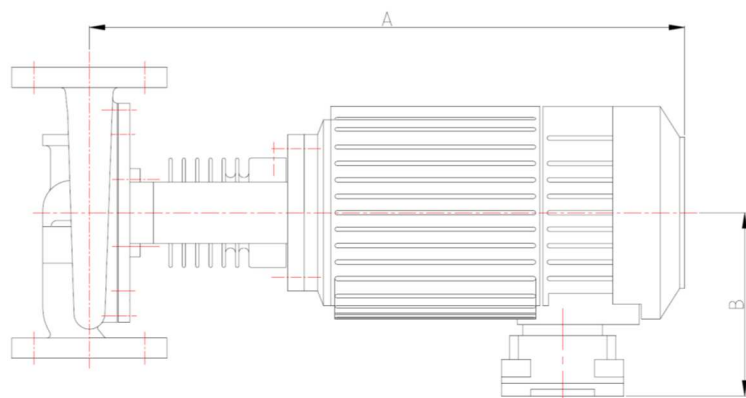
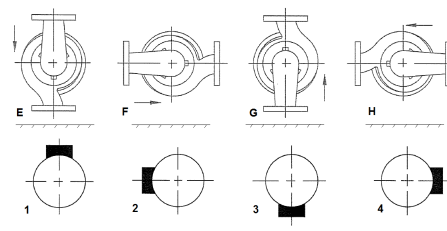

Dimensions shown are for reference only and can be different according to the type of motor used.

## PART NUMBER

LR	317		F	-	165	-	2,2	-	2	I	-	26503
	Size	Number of impeller	Material in contact with the liquid		Ø of the impellers		Power in kW		Motor installed			Serial No.
	317	1 impeller	F Nodular Cast Iron						2 2 poles (# 2 900 rpm)	Protection		
	517		A Carbon Steel						4 4 poles (# 1 450 rpm)	A ATEX		
	613/34									I non-ATEX		

## POMPES GROSCLAUDE

Parc du chêne - 29, rue du 35<sup>ème</sup> régiment d'aviation  
69 500 BRON – FRANCE

Tel: (33) 4 72 37 94 00

Fax: (33) 4 72 37 94 01

E-mail: [info@pompes-grosclaude.com](mailto:info@pompes-grosclaude.com)

Web: [www.pompes-grosclaude.com](http://www.pompes-grosclaude.com)

