

# EVX-BVX series pumps

The **EVX-BVX** series **monocellular vortex** centrifugal pumps are specially designed for the transfer of aerated or suspended particle liquids.

Because they are secured to baseplates, the **EVX- BVX** pumps can be used for a wide variety of industrial purposes. Assembly using spacer coupling makes maintenance much easier.

Different types of API-conformed tightness are available and the mechanical seals conform with **DIN 24 960**.

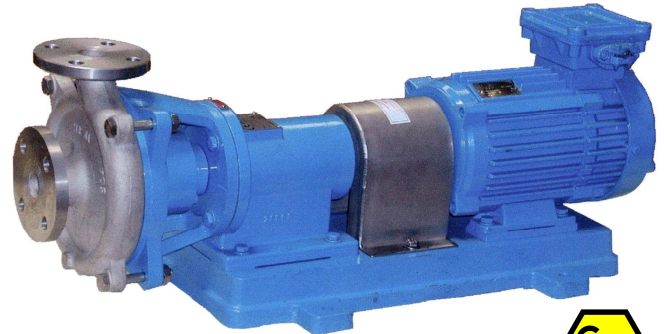

## LIMITS OF USE

- Flow rate: 100 l/h to 100 m<sup>3</sup>/h
- Total head: < 40 m
- Operating temperature: - 40°C to + 200°C
- Operating pressure: < 10 bar
- Speed: ≤ 3600 rpm
- Particles:
  - Size: < 1 cm (*or more on request*)
  - Deformable/hard: Compatible
  - Fragile: Respect their integrity
- ATEX certification:  II 2 G II B T2/T3/T4

## OPERATING PRINCIPLE

The **Vortex impeller**, placed at the back of the volute, creates a "whirlpool" movement. This centrifugal force allows efficient transfer of suspended solids by raising pressure at the pump's outlet.

The impeller is set back from the pump body's outlet axis and doesn't have direct contact with the suspended particles. Its position allows for **complete passage** of process fluid.

This vortex-effect hydraulic technology considerably reduces **any risk of clogging** and also accommodates pumping aerated or gas-containing liquids.

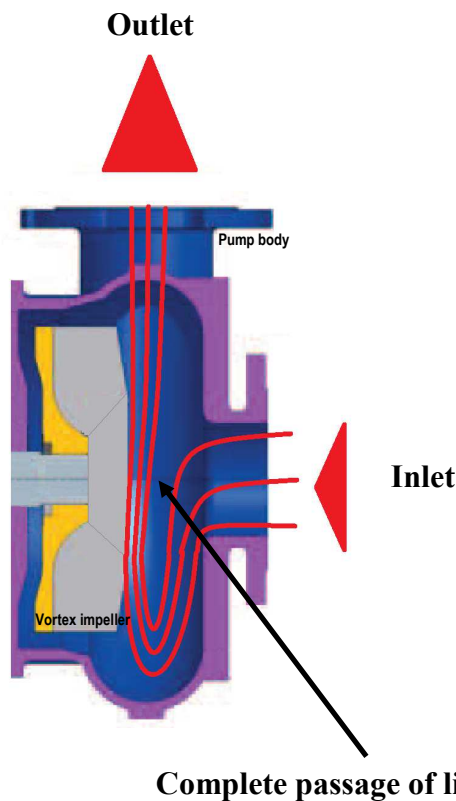

Semi-open impellers

## BUSINESS ACTIVITIES AND PRINCIPAL USE

Plant extracts - Paper-making industry - Surface treatment industry - Transfer of abrasive suspended solids - Transfer of liquids containing gas and air, fragile or fibrous products, etc.

# SPECIFICATIONS

## Basic components

- Pump body 316L Stainless steel
- Cover/diffuser/flange 316L Stainless steel
- Impeller 316L Stainless steel
- Shaft 329LN Stainless steel
- Gasket Aramid

To better respond to your requirements, our expertise in the metalworking industry is at your service:  
**Hastelloy, Uranus, Inconel, Monel, Titanium...**  
 (can be modified according to your needs)

## Mechanical seal

- Assembly Simple, double back to back, or tandem mechanical seal
- Lubrication Process fluid
- Friction faces SiC/C
- O-ring FPM

We'll help you define the best type of assembly and dynamic sealing adapted to your application.



## Pump inlet and outlet connections

Type	EVX 210	EVX 216	EVX 312	BVX 316	EVX 414	BVX 516	BVX 522	BVX 614	BVX 619	BVX 827
Inlet	DN20PN16	DN25PN16	DN32PN16	DN50PN16	DN40PN16	DN80PN16	DN65PN16	DN65PN16	DN80PN16	DN100PN16
Outlet	DN20PN16	DN25PN16	DN32PN16	DN32PN16	DN40PN16	DN50PN16	DN50PN16	DN65PN16	DN65PN16	DN80PN16

Motor Three-phase (other voltage on request)

Paint Primer + epoxy paint RAL # 5017

# OVERALL DIMENSIONS

2900 min<sup>-1</sup>

Type	Motor		Size Data						Weight (kg)
	Power (kW)	Number of poles	K (mm)	A (mm)	B (mm)	C (mm)	H (mm)	S (mm)	
EVX 210	0,37	4	44	580	230	210	101	211	37
EVX 210	0,75	2	44	580	230	210	101	211	40
EVX 216	0,37	4	60	715	262	280	140	270	59
EVX 312	0,37	4	73	745	262	280	140	270	58
EVX 312	2,20	2	73	845	305	280	140	270	77
BVX 316	1,10	4	80	835	316	290	167	327	100
BVX 316	7,50	2	80	1115	445	400	195	355	170
EVX 414	0,55	4	70	745	262	280	140	185	75
EVX 414	4,00	2	70	885	335	290	155	300	95
BVX 516	2,20	4	100	995	350	320	182	362	144
BVX 516	11,00	2	100	1185	445	400	195	375	200
BVX 522	3,00	4	115	1015	360	320	182	382	153
BVX 522	22,00	2	115	1285	530	450	263	463	295
BVX 614	1,10	4	81	885	331	320	182	352	105
BVX 614	7,50	2	81	1155	445	400	195	365	177
BVX 619	3,00	4	80	835	460	320	182	402	144
BVX 619	18,50	2	80	1115	530	450	263	483	265
BVX 827	15,00	4	125	1335	550	450	303	573	280

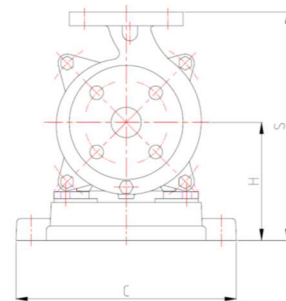
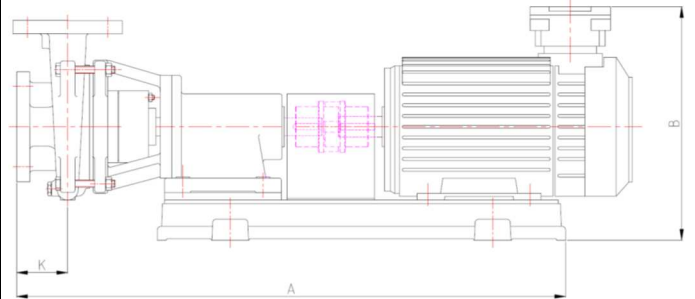

You can choose the position of the outlet and inlet when ordering

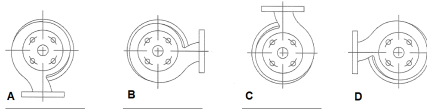

Our standard is C orientation.

Dimensions shown are for reference only and can be different according to the type of motor used.

# PART NUMBER

EVX	210	X	108	0,75	2	A	27555
Type	Size	Material in contact with the liquid	∅ of the impellers	Power in kW	Motor installed	Protection	Serial No.
EVX Lantern	109	X Stainless Steel 316L			2 2 poles (# 2 900 rpm)	A ATEX	
BVX Frame	210	F Ductile Cast Iron			4 4 poles (# 1 450 rpm)	I non-ATEX	
	...	U Duplex Stainless Steel					
	619	C Hastelloy C276					
	827	Ti Titanium					

# POMPES GROSCLAUDE

Parc du chêne - 29, rue du 35<sup>ème</sup> régiment d'aviation  
 69 500 BRON – FRANCE

Tel: (33) 4 72 37 94 00

Fax: (33) 4 72 37 94 01

E-mail: [info@pompes-grosclaude.com](mailto:info@pompes-grosclaude.com)

Web: [www.pompes-grosclaude.com](http://www.pompes-grosclaude.com)

